

# STEP 4



Download REFCO App from Apple Store for iOS or from Google Play Store for Android.

After installing the App on your mobile device prepare for pairing with TAP:

- 1.) Make sure TAP-CLAMP and TAP are switched on
- 2.) Make sure **slider switch** is in **Online** position on TAP
- 3.) To pair TAP with your mobile device, open REFCO App.
- 4.) Make sure your wireless connection (BT) is ON on smartphone or tablet.
- 5.) Touch the field blue for low side or red for high side to scan active TAP'S
- 6.) Choose required TAP to connect. (*TAP1 for low side etc.*)
- 7.) Repeat same procedure with TAP 2 for high side. (*TAP2 for high side etc.*)
- 8.) Repeat same procedure if more TAPs are needed to connect with App. Max up to 6 TAP possible.

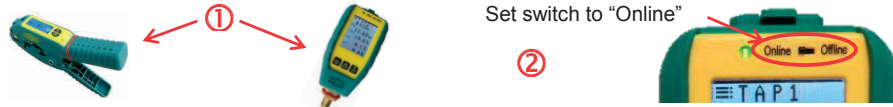

Set switch to "Online"

Touch to scan	Choose TAP	Connect	Paired

Repeat same procedure for high side.

Swipe from on page to the other if more TAP needed to connect.

TAP1 / TAP2	TAP3 / TAP4	TAP5 / TAP6

## Set refrigerant

TAP	APP
<ol style="list-style-type: none"> <li>1) Press MENU button long to enter select mode.</li> <li>2) Scroll to refrigerant menu by pressing DOWN button short. Enter by pressing SET button long</li> <li>3) Press UP or DOWN button to select desired refrigerant type.</li> <li>4) Press SET button to confirm.</li> <li>5) Refrigerant is set at TAP.</li> </ol>	<p>Select the same desired refrigerant from the table on App.</p>

# Quick Start Guide (English) TAP Temperature And Pressure Gauge



TAP-CLAMP	TAP	iOS App	Android App
Temperature clamp	Pressure gauge	Download REFCO App from Apple Store for iPhone or iPad version 8.0 or higher.	Download REFCO App from Google Play Store for phone or tablet version 4.4 or higher.

TAP-SET:	1 TAP-CLAMP (Temperature clamp) / 1 TAP (Pressure gauge)
TAP-DOUBLE-SET	2 TAP-CLAMP (Temperature clamps) / 2 TAP (Pressure gauges)

## STEP 1

Insert batteries into TAP-CLAMP and TAP (pressure gauge)

TAP-CLAMP	TAP
Insert 3 x AAA batteries	Insert 4 x AAA batteries

Note: Inside the battery case, serial number is visible.

Example of TAP-CLAMP	Example of TAP

## STEP 2

### Set ID (Identification number)

Set ID for **TAP-CLAMP** if not already set.

For example:

- **Low side** (TAP-CLAMP with **blue** marking ring) set **T1**
- **High side** (TAP-CLAMP with **red** marking ring) set **T2**

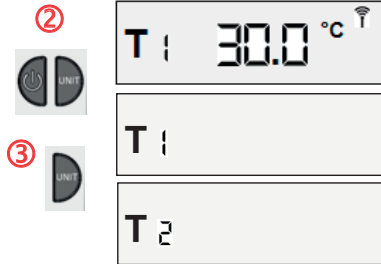

ID numbers from T1 to T6 possible

- 1.) Switch on TAP-CLAMP
- 2.) Press [ON/OFF] & [UNIT] button same time, briefly, to enter set mode. \*
- 3.) Scroll from T1 to T6 by pressing [UNIT] button briefly.
- 4.) Press [ON/OFF] button, long, to confirm and return to main display.

Note: Once set ID, number remains.

(\* if you keep by mistake holding the two buttons longer than 1sec. you will enter auto shutoff timer mode. To escape from auto shutoff mode press On button again.)

### Set ID for TAP (pressure gauge) if not already set.

For example:

- **Low side** (TAP with blue marking ring) set **TAP1**
- **High side** (TAP-CLAMP with red marking ring) set **TAP2**

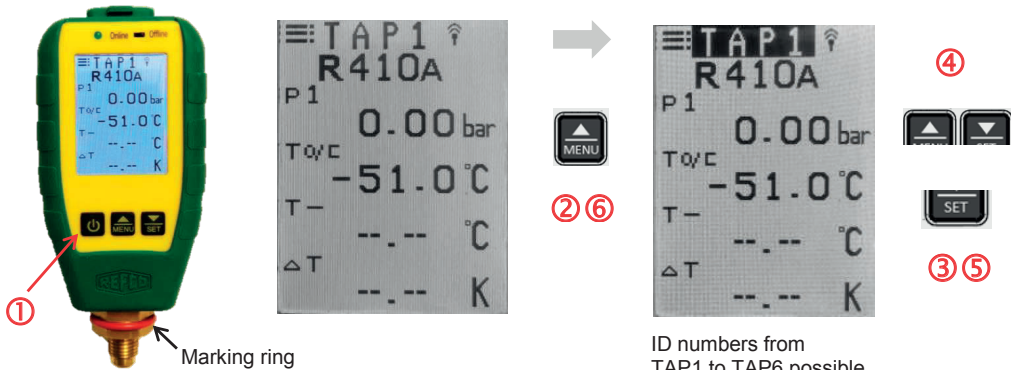

ID numbers from TAP1 to TAP6 possible

- 1.) Switch on TAP: Press [ON/OFF] button until start image appears.
- 2.) Press [MENU] button, long, to activate selection mode.
- 3.) Press [SET] button, long, to enter TAP ID menu.
- 4.) Choose TAP ID number by pressing [▲] or [▼] button, briefly.
- 5.) Press [SET] button, long, to confirm selected ID number.
- 6.) Press [MENU] button, long to return to main display.

Note: Once set, ID remains

## STEP 3

### Pairing between TAP-CLAMP and TAP

1.) Switch **TAP-CLAMP ON first** -> transmitting symbol is flashing



2.) **Second** switch ON **TAP gauge** -> transmitting symbol is flashing

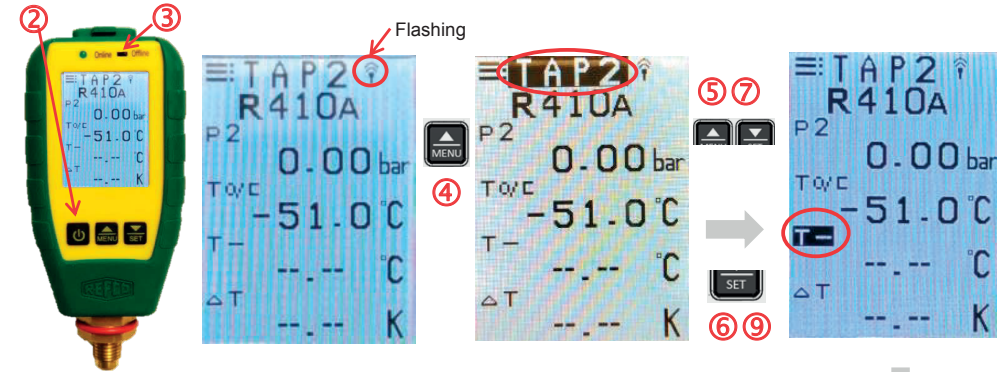

- 3.) Set sliding switch on device to "online".
- 4.) Press [MENU] button, long, to activate selection mode
- 5.) Press [SET] button, long, to start scanning. (Search for TAP-CLAMP)
- 6.) If device be found, display shows a list of found TAP CLAMP ID(s).
- 7.) Select desired TAP-CLAMP ID by pressing [▲] or [▼] button, short.
- 8.) Press [SET] button, long, to start pairing.
- 9.) If pairing was successful, display shows "END"
- 10.) Transmit symbols become solid on TAP and TAP-CLAMP
- 11.) Temperature from TAP-CLAMP is visible on TAP

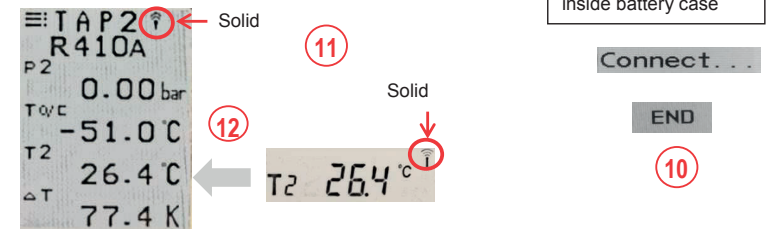

Repeat same procedure with TAP-CLAMP T2 and TAP2

Note:

If TAP-CLAMP is switched on first, TAP will find TAP-CLAMP immediately again.

If TAP is switched on first, procedure for searching TAP-CLAMP is required.

Further instructions see manual.